

PROJECT :
PROPOSED B+2 COMMERCIAL BLOCK AT JOYVILLE-AFFORDABLE HOUSING, HOWRAH

AREA STATEMENT

GROUND FLOOR AREA	921.354 SQ.M.
FIRST FLOOR AREA	890.697 SQ.M.
SECOND FLOOR AREA	910.857 SQ.M.
TOTAL AREA	2722.908 SQ.M.

KEY PLAN

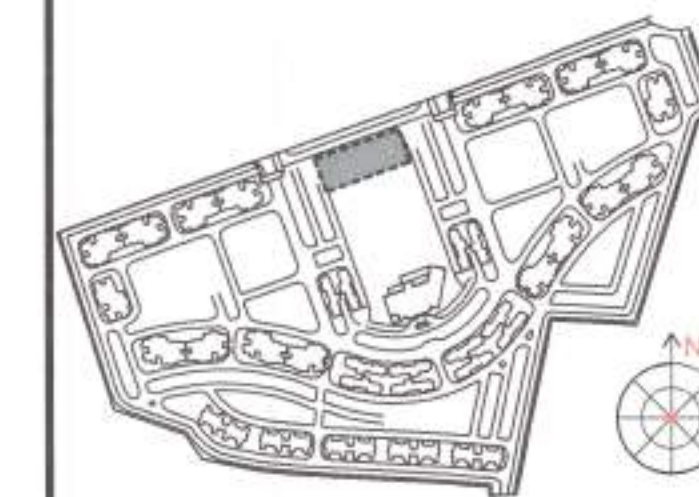

THE STRUCTURAL DESIGN & DRAWINGS OF BOTH FOUNDATION & SUPERSTRUCTURE OF THE BUILDING HAS BEEN MADE BY ME CONSIDERING ALL POSSIBLE LOADS INCLUDING THE SEISMIC LOAD AS PER THE NATIONAL BUILDING CODE OF INDIA CERTIFIED THAT IT IS SAFE AND STABLE IN ALL RESPECT.

This Plan is Provisionally approved
 Subject to the changes as marked & Compliances of recommendations issued.

[Signature]
 Divisional Fire Officer
 Howrah Dtn.
 WEST BENGAL FIRE & EMERGENCY SERVICES

[Signature]
SANJIV PAREKH
 M.E. (STRUCT. & E. (CONST. ENG.)),
 R. C. E. / F.I.E. (F-018202-4)
 E. S. E. NO. 104 (I) K. M. C.

THE PLOT HAS BEEN INSPECTED BY ME AND ON THAT BASIS I DO CERTIFY WITH FULL RESPONSIBILITY THAT THE PROPOSED BUILDING PLAN HAS BEEN DRAWN AS PER PROVISION OF K.M.D.A. DEVELOPMENT CONTROL REGULATIONS & BUILDING BYE LAWS FOR KOLKATA WEST INTERNATIONAL CITY.

[Signature]
SUTANU CHATTACHARY
 Registered Architect
 Council of Architecture
 Regn. No. CA/92/15324

CLIENT:
KOLKATA WEST INTERNATIONAL CITY SALAP MORE, HOWRAH

DESIGN ASSOCIATE (ARCH, STR & MEP)
SHAPOORJI PALLONJI ENGINEERING & CONSTRUCTION

CONTENT :
FIRST & SECOND FLOOR PLAN

SCALE	1:100	DRG. NO.	SBA/KWIC/COMM/SANC-03
DATE	31.07.2020		
DEALT			
CHKD.			



SECOND FLOOR PLAN

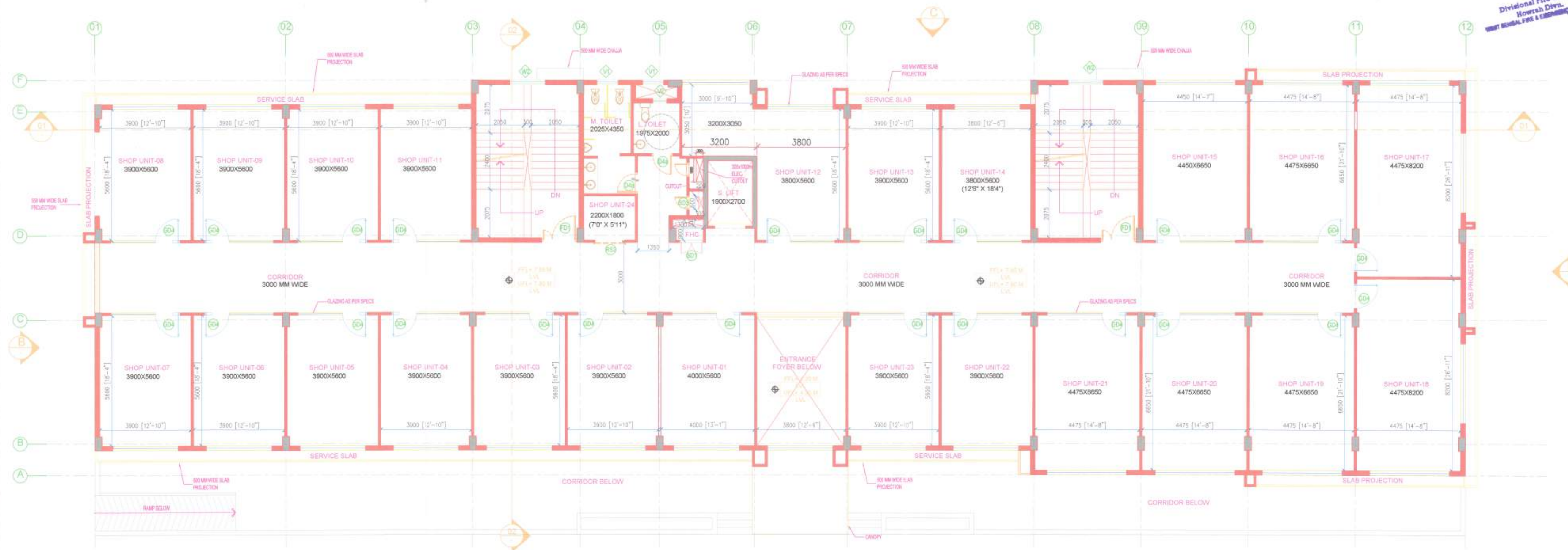

FIRST FLOOR PLAN